

PARTS LIST

ITEM PART	DESCRIPTION	QTY
1 ZV-925	Glazing Vinyl	1
2 ZD-2503	Hinge Rail with Vinyl	1
3 ZV-903	Glazing Vinyl Bottom Rail	1
4 ZD-1002	Bottom Rail	1
5 #6X1/4	#6 x 1-1/4" Screws	3
6 ZV-904	Splash Vinyl	1
7 ZD-1008	Drip Trough	1
8 ZV-905	Drip Plug	1
9 ZV-940	Bottom Rail End Cap	1
10 ZV-955	Hinge Jamb Sleeve Vinyl	1
11 ZD-2505	Hinge Jamb	1

ITEM PART	DESCRIPTION	QTY
12 ZV-945	Hinge Pins	2
13 ZD-1013	Hinge Bushings	2
14 ZD-1009	Hinge Clips	2
15 ZD-1006	Wall Channels	2
16 ZV-935	Wall Anchors	6
17 #8X1/2"	#8 x 1-1/2" Screws	6
18 ZD-1004	Latch Jamb w/ZV-908 Vinyl	1
19 ZV-914	3" Handle Vinyl	1
20 MAG4011-3	3" Mag Door Pull	1
21 #6X3/8"	#6 x 3/8" Screws	6
22	Mag Channel	1

When ordering repair parts, please provide the following information:

1. Model Number
2. Part Number
3. Part Description
4. Finish Color

Required Tools:

To install your shower enclosure, you will need the following:

- Level
- #31 Drill Bit
- 3/16" Carbide Drill Bit (for tile walls)
- Phillips Screwdriver
- Silicone
- Hack Saw
- 1/4" Box End Wrench

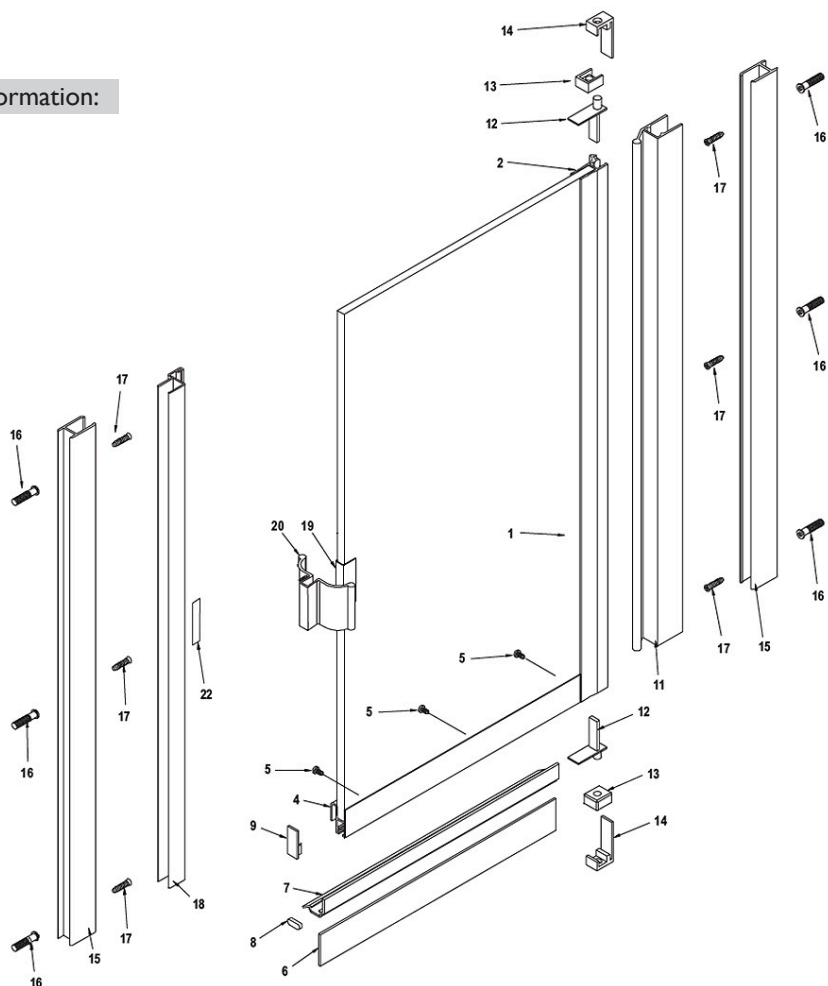

INSTRUCTIONS:

Note: Assembly of a hinge-left door is shown in Figure 1. For a hinge-right door, place bottom rail assembly at opposite side.

1. Lay glass flat, smooth side up on assembly table (Figure 1) and bracing glass on far side as shown so hinge rail can be driven into place. Apply hinge rail glazing channel (1) to edge of glass nearest you. Start vinyl 5/8" up from the bottom of the glass and cut flush with the top of glass.
2. The hinge jamb and hinge rail (11 & 12) are packaged assembled. Before glazing the hinge rail (2), remove hinge jamb (11) and sleeve (10) from hinge rail. Failure to do so will cause damage to metal while glazing and result in the door hinge binding. Hold hinge rail in place against vinyl with a glazing block and glaze using a hammer. Hinge rail should extend 3/4" below bottom of glass (Figure 2) and be straight from end to end.
3. Apply bottom glazing vinyl (3) to the bottom of the glass. Hold bottom rail (4) in place against the bottom glazing channel and drive the bottom rail in place on the glass using the glazing block and a heavy steel hammer. Secure hinge rail to bottom rail using one #8x 1-1/4 FH SMS screw. Start three #6 x 1/4" SMS B screws (5) into the bottom rail. Insert the splash vinyl (6) and the drip trough (7) into the bottom rail. Splash vinyl should flush off with latch end of bottom rail and butt to offset of the hinge rail at other end. Flush-off drip trough with notch back on bottom rail at latch side. Push drip trough as far up as possible on latch side and as low as possible on hinge side and secure by tightening the three #6 x 1/4" SMS B screws (5).
4. Insert the drip plug (8) into the end of the drip trough at the handle side. Water should now drain back into the shower when the door is open. Insert the bottom end rail cap (9) in the end of the bottom rail (4) (see Figure 3).
5. Set hinge bushing (13) in place over the hinge clip (14) and push the hinge pin (12) into the hinge bushing. Drive the clip with the bushing and pin into the bottom end of the hinge jamb (See Figure 4). Slip the hinge jamb sleeve (10) over ball of hinge jamb. Place the hinge jamb with sleeve, clip, bushings, and pin in place inside the hinge rail. (Screw holes in hinge jamb to the inside of door). Slip the second pin in place in the hinge rail at the top of the door; place the bushing over the clip and drive the clip into the jamb securing the pin to the bushing.

General: Wall channels (15) are supplied 67 3/4" long. For door only installation (with no header or curb), cut with a hacksaw to 66 5/8" so they will not extend above the hinge and latch jambs.

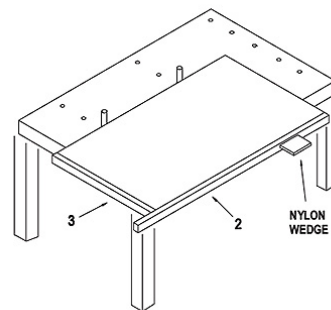

FIGURE 1

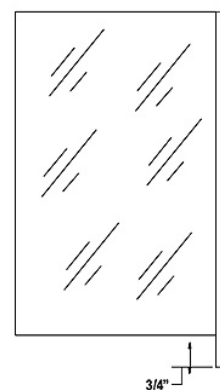

FIGURE 2

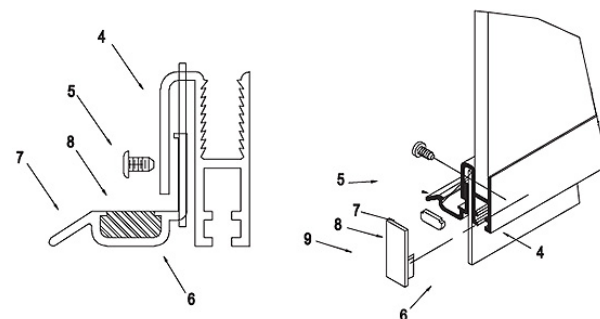

FIGURE 3

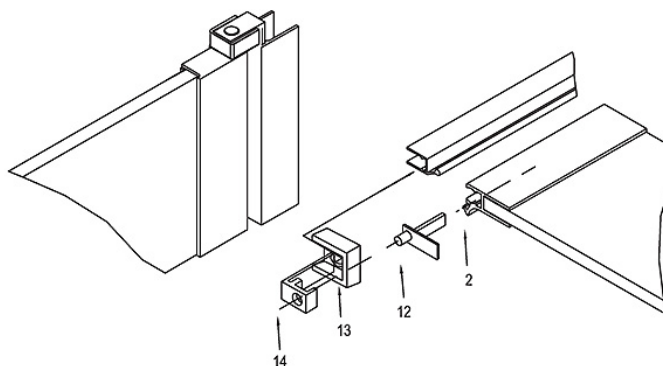
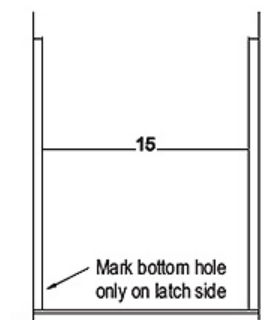
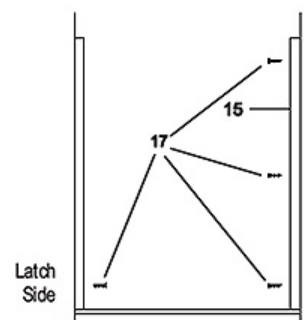

FIGURE 4

6. Hold wall channels (15) in a plumb position and mark hole locations on the hinge side and bottom hole only on the latch side (See Figure 5). Drill holes in wall (using 3/16" carbide drill for tile walls). Insert wall anchors (16) into drilled holes.
7. Set wall channels in place and secure with #8 x 1-1/4" screws (17) using bottom screw only on latch side (See figure 6). NOTE: Door is adjustable up to 1" (1/2" at hinge jamb and 1/2" at latch jamb). Example: A CD-24 door will fit an opening 24" to 25". The 1/2" adjustment should also be used to correct out- of-plumb conditions. For openings up to 24 1/2", set hinge jamb all the way over the wall channel and adjust latch jamb to meet door. For openings over 24 1/2" adjust hinge jamb out on wall channel to compensate for additional opening width.

FIGURE 5

8. Set latch jamb (18) in place over wall channel, but DO NOT SECURE!
9. Set hinge jamb with door attached (2 & 11) in place over wall channel. Adjust laterally, plumb to fit opening. Mark three holes on wall channel through the predrilled holes on hinge jamb. Drill three holes with a #31 drill bit and secure with #6 x 3/8 SMS screws (21).

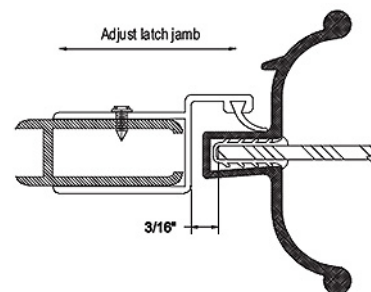
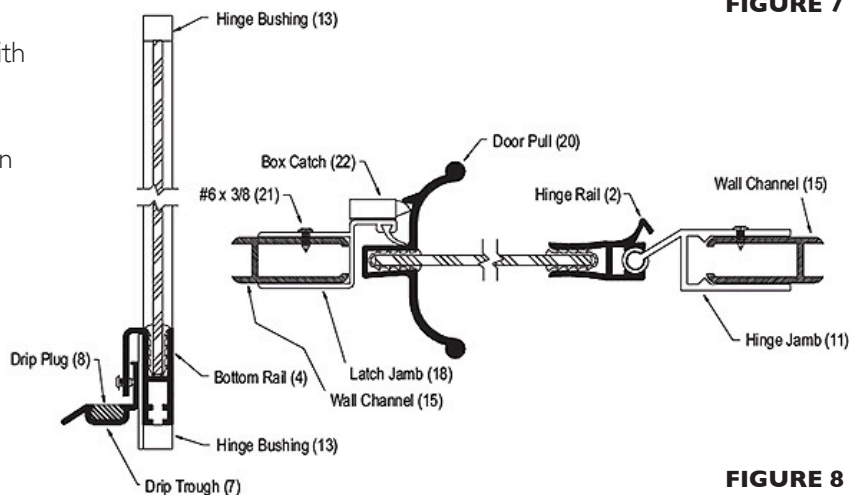

FIGURE 6

10. Apply 3" vinyl channel (19) to edge of glass, centered on handle side. Tap handle (20) in place over vinyl channel.
11. Align latch jamb (18) with edge of door glass and mark wall channel (15) location on wall. Remove latch jamb and mark holes on wall. Lean wall channel to one side to allow enough room for drill and drill the remaining two holes on wall. Insert wall anchors (16).
12. Replace wall channel and secure remaining two holes in wall channel using two #8 x 1-1/4" screws (17).
13. Replace latch jamb over wall channel. Close door and adjust latch jamb 3/16" from edge of glass (See figure 7). Through the holes provided in the latch jamb, drill three #31 holes in wall channel. Secure latch jamb to wall channel with #6 x 3/8 SMS screws (21).

FIGURE 7

14. Set catch (22) in place on latch jamb (18) and secure with #6 x 1/4" screws (5).
15. Adjust drip trough (7), up at latch side of door and down at hinge side of door so water will drain into shower when door is opened. Adjust splash vinyl (6) to within 1/8" of curb. NOTE: Splash vinyl should not touch curb.

16. Clean area to where sealant is to be applied and run a bead of sealant full length inside and outside of each wall channel, where channel meets wall. Allow sealant to cure for 24 hours.

FIGURE 8

**BREAKDOWN CHART FOR SPECIAL HEIGHT
AND WIDTH CD UNITS:**

QTY.	Part# & Description	How to arrive at measurement
2	ZD 1006 Wall Channels*	Unit height
1	ZD 2505 Hinge Jamb	Unit height
1	ZD 1004 Latch Jamb	Unit height
1	ZD 2503 Hinge Rail	Unit height minus 7/8"
1	ZD 1002 Bottom Rail	Glass width (see chart) minus 1 1/16"
1	ZD 1008 Drip Trough	Glass width (see chart) minus 3/16"

Glass

1	Unit Width	Unit width minus 3-3/16"
	Height	Unit height minus 1-5/8"

DOOR SIZE AND METAL CHART:

Model #	Opening Size	Glass Size	ZD 1002	ZD 1008	ZD 904 wiper
CD-22	22-23	18 13/16 x 65	18-1/8"	18"-5/8"	20"
CD-23	23-24	19 13/16 x 65	19-1/8"	19"-5/8"	21"
CD-24	24-25	20 13/16 x 65	20-1/8"	20"-5/8"	22"
CD-25	25-26	21 13/16 x 65	21-1/8"	21"-5/8"	23"
CD-26	26-27	22 13/16 x 65	22-1/8"	22"-5/8"	24"
CD-27	27-28	23 13/16 x 65	23-1/8"	23"-5/8"	25"
CD-28	28-29	24 13/16 x 65	24-1/8"	24"-5/8"	26"
CD-29	29-30	25 13/16 x 65	25-1/8"	25"-5/8"	27"
CD-30	30-31	26 13/16 x 65	26-1/8"	26"-5/8"	28"
CD-31	31-32	27 13/16 x 65	27-1/8"	27"-5/8"	29"
CD-32	32-33	28 13/16 x 65	28-1/8"	28"-5/8"	30"
CD-33	33-34	29 13/16 x 65	29-1/8"	29"-5/8"	31"
CD-34	34-35	30 13/16 x 65	30-1/8"	30"-5/8"	32"
CD-35	35-36	31 13/16 x 65	31-1/8"	31"-5/8"	33"
CD-36	36-37	32 13/16 x 65	32-1/8"	32"-5/8"	34"